

Friday, February 21, 2020 4:05:57 PM E:\2019\19032.00\Food Lion 1238\New Market ACHN Working\AutoCAD\1238 A1.05\_00.dwg

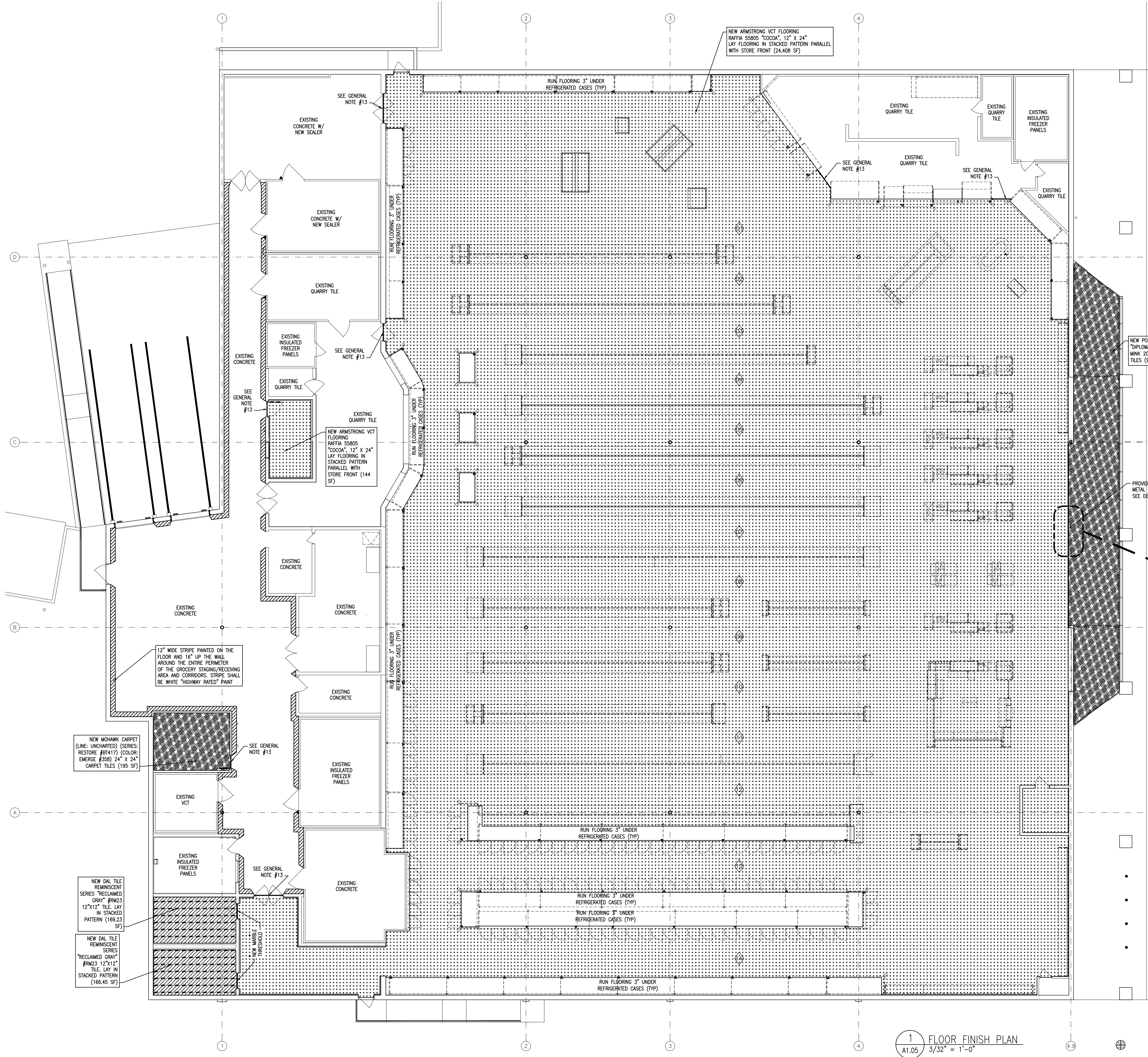

1 FLOOR FINISH PLAN  
A1.05 3/32" = 1'-0"

FLOOR FINISH LEGEND:

- REFER TO SPECIFIC AREA NOTE FOR  
DIRECT FLOORING INFORMATION
- NEW PERIMETER/FULL  
VCT FLOORING
  - NEW CENTER  
STORE/PATCH &  
REPAIR VCT FLOORING
  - NEW 2" BORDER TILE
  - NEW RESINOUS  
DECORATIVE FLOORING
  - NEW PORCELAIN TILE
  - NEW QUARRY TILE
  - NEW SURECRETE CONCRETE SEALER
  - NEW CARPET TILES
  - NEW CONCRETE
  - 12" WIDE PAINTED RAT STRIPE

GENERAL FLOORING NOTES:

1. VINYL FLOOR TILE (VCT)  
SEE SPECIFICATIONS FOR ACCEPTABLE ADHESIVE FOR VINYL COMPOSITION TILE (VCT).
2. THE VINYL COMPOSITION TILE SHALL BE 1/8" MANUFACTURED BY ARMSTRONG.
3. THE GENERAL CONTRACTOR SHALL FURNISH AN ADDITIONAL 5% OF EACH COLOR OF VCT TO BE LEFT AT THE STORE, COORDINATE WITH THE FOOD LION CONSTRUCTION MANAGER.
4. THE GENERAL CONTRACTOR SHALL THOROUGHLY CLEAN AND WAX (2 COATS MINIMUM) VCT IMMEDIATELY AFTER INSTALLATION. ONLY USE CLEANER AND WAX PRODUCTS RECOMMENDED BY THE FLOOR MANUFACTURER.
5. THE FLOORING INSTALLER SHALL PERFORM A CALCIUM CHLORIDE OR HUMIDITY TEST FOR EACH 1,000 SQUARE FOOT AREA WHERE FLOORING WILL BE INSTALLED. THE INSTALLER SHALL PROVIDE A REPORT TO THE FOOD LION CONSTRUCTION REPRESENTATIVE FOR ALL AREAS THAT MOISTURE FALLS ABOVE 5 POUNDS, AND PROVIDE AN APPROPRIATE DAMP PROOF MEMBRANE.
6. THE GENERAL CONTRACTOR SHALL ALTERNATE THE FIELD TILES:
7. CARPET/MAT TILE  
ENTRANCE FLOOR TILE SHALL BE "DIPLOMAT" BY PORTICO SYSTEMS WITH TAC FAST BACKING. COLOR SHALL BE "MINK". DIPLOMAT SHALL BE INSTALLED BY PORTICO SYSTEMS. CONTACT GREG GRIFIN (864) 527-3148. THE GENERAL CONTRACTOR SHALL FURNISH 5% EXTRA OF THE TOTAL AMOUNT OF DIPLOMAT USED, TO BE LEFT IN THE BACK ROOM OF THE STORE FOR FUTURE USE.
8. PHARMACY CARPET, WHEN APPLICABLE, SHALL BE "DIPLOMAT" BY PORTICO SYSTEMS WITH TAC FAST BACKING. COLOR SHALL BE "MINK". DIPLOMAT SHALL BE INSTALLED BY PORTICO SYSTEMS. CONTACT GREG GRIFIN (864) 527-3148. THE GENERAL CONTRACTOR SHALL FURNISH 5% EXTRA OF THE TOTAL AMOUNT OF DIPLOMAT USED, TO BE LEFT IN THE BACK ROOM OF THE STORE FOR FUTURE USE.
9. CONCRETE FLOORING  
ALL PRODUCTS FOR UNDERLAYMENT OF VCT SHALL BE MAPEI TO PROVIDE A COMPLETE MAPEI SYSTEM. SEE SPECIFICATIONS.
10. IN AREAS WHERE FLOOR DRAINS OCCUR, THE FINISH FLOOR SHALL SLOPE 1/16" PER FOOT TO DRAIN.
11. SEAL ALL EXPOSED CONCRETE FLOORS WITH AN EXTRA COAT OF CONCRETE SEALER ONE WEEK PRIOR TO GROCERY DELIVERY. SEALER TO BE PER SPECIFICATIONS. COORDINATE WITH FOOD LION CONSTRUCTION MANAGER.
12. THE GENERAL CONTRACTOR SHALL USE 10 MIL VAPOR RETARDER AT CONCRETE SLAB EDGES AND 30 LBS. FELT AROUND INTERIOR COLUMNS. NO EXPANSION JOINT MATERIAL SHALL BE USED.
13. THE GENERAL CONTRACTOR SHALL INSTALL A 5" WIDE 11GA (1/8" THICK) STAINLESS STEEL THRESHOLD WITH COUNTERSUNK SCREWS AND SET IN A FULL BED OF SILICONE TO THE FLOOR FOR DISSIMILAR FLOOR FINISHES (RESINOUS FLOOR AND CONCRETE, VCT AND CONCRETE, RESINOUS FLOOR AND VCT, QUARRY TILE & VCT). GC SHALL INSTALL A BEVELED ADA COMPLIANT MARBLE THRESHOLD AT RESTROOM DOORS (4' WIDE x 5/8" HIGH).
14. EXTERIOR SURECRETE APPLICATION SHALL BE SURECRETE DESIGN PRODUCTS "SURESPRAY PEBBLE TEXTURE" COLOR "FL100". GC SHALL SEAL WITH SUREDECK SOLVENT-BASED OR SURESEAL WATER-BASED PIGMENTED SEALER.
15. RESINOUS DECORATIVE FLOORING  
ALL PRODUCTS FOR UNDERLAYMENT OF VCT SHALL BE MAPEI TO PROVIDE A COMPLETE MAPEI SYSTEM. SEE SPECIFICATIONS.
16. RESINOUS DECORATIVE FLOORING SHALL BE PURCHASED FROM DUR-A-FLEX INC. CONTACT KEVIN STEPHENS AT (919) 208-8662 OR FROM PROTECTIVE INDUSTRIAL POLYMERS, CONTACT STEVE MCOWNEY AT (864) 837-5000.
17. GROUNDWATER-RESINOUS FLOOR-LAYOUT WITH GASE-INSTALLER
18. THE GENERAL CONTRACTOR SHALL CLEAN ALL EXISTING TILE IN THE RESTROOMS, MEAT PREP, MEAT COOLER, MEAT STORAGE, DELI/BAKERY PREP, DELI/BAKERY COOLER AND DELI/BAKERY STORAGE. ANY REPAIR OR RENOVATIONS TO BE DONE WITH MATCHING MATERIALS. COORDINATE ALL WORK WITH THE PLUMBING, SLAB AND DEMO PLANS ALONG WITH THE FOOD LION CONSTRUCTION MANAGER PRIOR TO COMMENCING WORK.
19. INSTALL NEW QUARRY, CERAMIC OR PORCELAIN TILE AT A 90° ANGLE TO THE WALL, UNLESS OTHERWISE NOTED; LEVEL WITH FINISHED FLOOR. MATCH EXISTING.
20. RESTROOMS, MEAT PREP, MEAT COOLER, MEAT STORAGE, DELI/BAKERY PREP, DELI/BAKERY COOLER AND DELI/BAKERY STORAGE SHALL HAVE EPOXY GROUT CONFORMING TO TSA AARI HT, ANSI A118.3, FOR ANY REPAIR/REMODEL WORK.
21. FLOOR TILE MANUFACTURER SHALL PROVIDE A LETTER CERTIFYING ALL TILES ARE SLIP RESISTANT IN ACCORDANCE WITH CABO/ANSI 117.1-2009 SECTION 302.

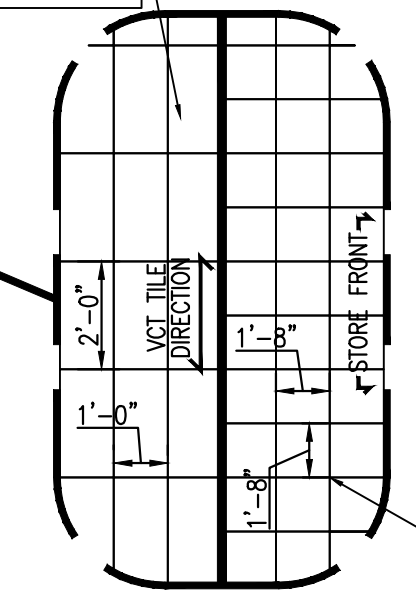

3 ENLARGED FLOORING DIRECTION DETAIL  
SCALE: N.T.S.

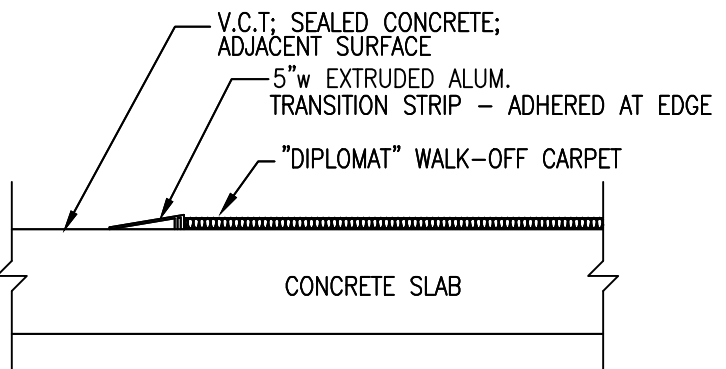

2 CARPET TRANSITION DETAIL  
A1.05 SCALE: N.T.S.

Professional Seals

"PROFESSIONAL CERTIFICATION"  
I certify that these documents were prepared or approved by me, and that I am a duly licensed architect under the laws of the State of Maryland. License number 13821, expiration date 08-30-2020.



Interior Alteration For:

**FOOD LION**

2110 Executive Drive, Salisbury, NC 28145 / PH: 704.633.8250

Store No. **1238**  
11800 Old National Pike  
New Market, MD 21774

OWNERSHIP OF INSTRUMENTS OF SERVICE:  
All reports, specifications, plans, computer files, field data, notes, and other documents and instruments of service shall remain the property of the Design Professional. The Design Professional shall retain all common law, statutory and other reserved rights, including the copyright therein.

This drawing is the property of Yates-Chreiberg-Hughes Architects, Corp. and is not to be reproduced or copied in whole or in part. It is not to be used on any other project and is to be returned upon request.

© Copyright 2020

Project No.: **1238FLMK20**

File Name: **1238 A1.05\_00.dwg**

Date: **02-14-2020**

Revisions:

FLOOR FINISH PLAN

Architectural

**A1.05**

YCH Commission Number

**19032.00**

**7035 Northwinds Dr NW**

**Concord, NC 28027**

**704 . 788 . 2000**

**ycharch.com**